

**SENTINEL<sup>®</sup>**

systemcare



# Best practice made simple...



We're proud to be endorsed by the industry's major manufacturing companies:



**SENTINEL<sup>®</sup>**

systemcare

**For more than 30 years we've delivered innovative, practical products and value added solutions to the heating industry.**

Sentinel SystemCare continues this legacy by ensuring best practice cleaning and protection of boilers and heating systems.

By using SystemCare, you can be confident that system life and efficiency are maximised at install and throughout the system's lifetime.

**The Sentinel System** Lifetime protection for heating and hot water systems using the best practice process of...

---



**CLEAN**



**PROTECT**



**MAINTAIN**



Our research shows that...

# 93%

of interviewees agreed that **incorrect water treatment will lead to future heating system issues** and increased lifetime costs.

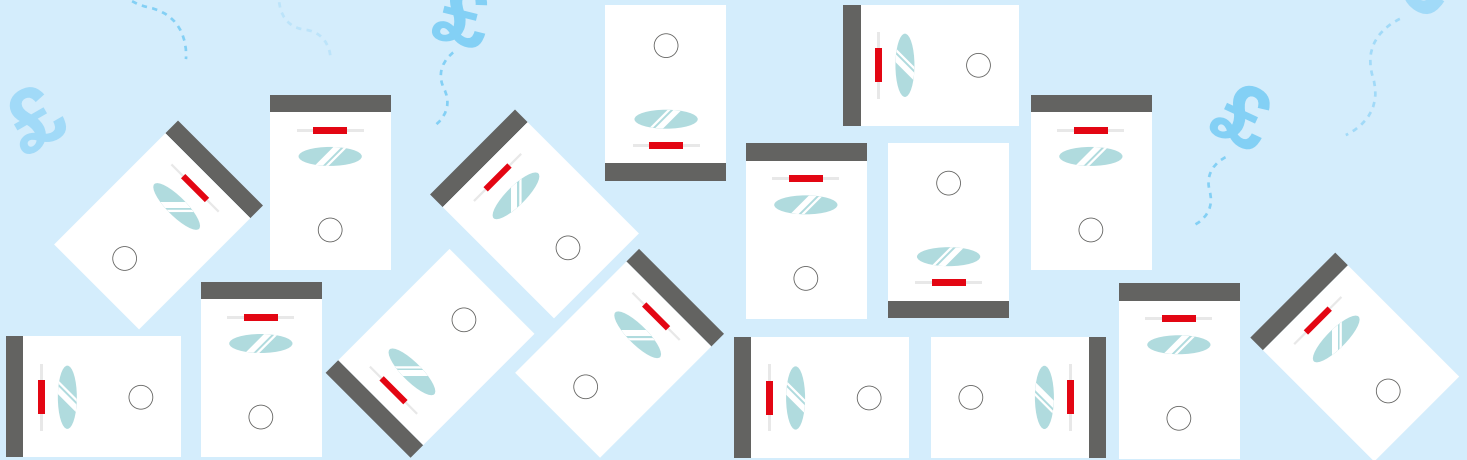

**When heating system components and boilers don't meet their expected lifespan, this has a negative impact on:**

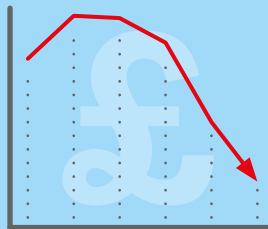

Budgets



Ability to progress other works



Tenant satisfaction

# Why SystemCare?

SystemCare has a proven track record of reducing cost and callbacks to help housing providers reach their heating and tenant satisfaction KPIs.

It's a bespoke blend of training and quality products designed to deliver lifetime boiler protection by providing everything the heating engineer needs in a single box.

Best practice water treatment is made as fast and as simple as possible for installation and servicing teams, enabling heating systems to be cleaned and protected in line with regulations and boiler manufacturer recommendations.

The blend of products, training and reporting is bespoke for each and every project, tailored to your requirements.



## The impact of SystemCare

### Installation and servicing



Ensures best practice cleaning and protection.



Protects against dirty radiators impacting new boiler installs.



Reduces future system issues, resulting in fewer visits to the property and increased tenant satisfaction.

### Extend boiler life



Ultimately Sentinel SystemCare has been designed to ensure that the cleaning and protection of the system is carried out to the highest possible standards, reducing lifetime costs and the likelihood of premature boiler failure.



# Sentinel Eliminator Vortex<sup>®</sup> filters

Sentinel SystemCare offers Eliminator Vortex filters as the perfect solutions for today's heating systems.

## Eliminator Vortex250

Great for fitting in tight spaces

### Why use Vortex250?

The Vortex250 combines ultra-compact size and high performance, as well as straightforward installation and service into one unit, ticking all the boxes for your projects.

### Fast installation

- Easily sited above or below boiler
- 360° rotational T-piece allows flexibility in fitting

### Powerful magnetic filtration

- 9000 Gauss magnet assembly - The most powerful ultra-compact filter on the market

### Simple servicing

- Isolate using integrated valve, remove magnet and flush using the secure anti-tamper drain valve
- The small space occupied, with no extra headroom required, allows a straightforward flush either above or below the boiler
- No tools required

Included in packs C and D - see inside back page for pack details

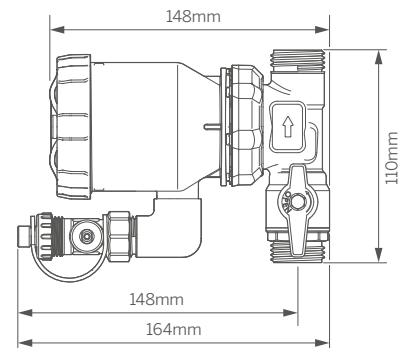

# Ultimate confidence

Our filters are engineered and tested to meet the same exacting standards we've demanded of our products since 1988. Each one comes with pressure tested dual seals and a 10 year total product guarantee for complete peace of mind.

## Eliminator Vortex300

Ideal when isolating is not a priority

### Why use Vortex300?

A compact unit designed to fit small spaces, which retains more magnetite than other leading small filters.

### Fast installation

- Compact 300ml unit designed to fit small spaces
- In-line installation with 360° positionable T-piece enables installation in minutes

### Powerful magnetic filtration

- 9000 Gauss magnet assembly

### Simple servicing

- Withdraw magnet and flush clean in seconds
- Remove collar and withdraw magnet assembly to show collected debris and clean: no tools required

Included in packs A and B - see inside back page for pack details



# SESI

Protect against hard water



In hard water areas, limescale has a costly impact on many areas of the home. Sentinel SESI is a low cost solution to help protect items such as combi-boilers, water heaters and hot water systems, brassware and shower heads, and household appliances.

## How does it work?

When the Sentinel SESI unit is fitted to the incoming mains it works by using an electrolytic process - releasing low levels of zinc into the water flow.

The zinc alters the structure of the scale so it doesn't form the hard and damaging layers that you would normally see on the surfaces of heating elements and pipes.



Untreated

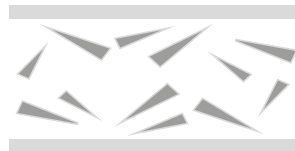

Treated

## Features and benefits

- Protects against limescale encrustation
- WRAS approved
- 5 year guarantee
- Performance proven by independent studies

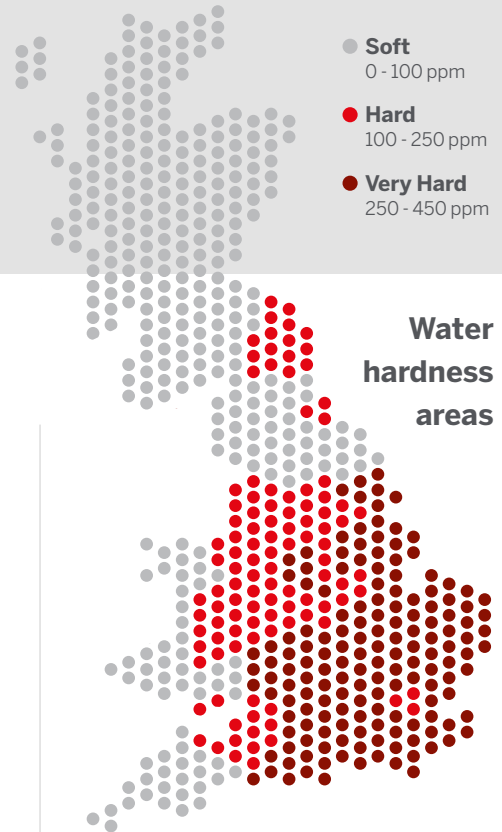

“Where the mains water hardness exceeds 200ppm, provision should be made to treat the feed water to water heaters and the hot water circuit of combination boilers to reduce the rate of accumulation of limescale”

Source: Domestic Building Services Compliance Guide 2013



# SystemCheck

Make your lab test work harder

Let your water analysis tell you more than ever before.



From one-off reports...



We've updated SystemCheck to allow you to track and analyse your lab test results online. Tests can now be uploaded in bulk, and performance data can be explored and exported through dashboards, all at your convenience.

Traditionally, water analysis ends when the report is issued. We've evolved SystemCheck to make water analysis smarter, giving you actionable insights.

New dashboard overview:

## Smarter data insights

- Track company performance across a variety of key metrics
- Explore individual engineer performance
- React quickly to any emerging issues with additional training

...to intelligent dashboards



Track average pass rate

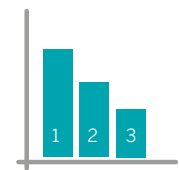

Identify repeat visits



Find frequent failure modes



# The SystemCare product package

We have developed a unique product and service package to improve heating system treatment at installation and reduce lifetime maintenance and servicing costs.



## Sentinel X800 Fast Acting Cleaner

Rapid cleaner for hot or cold systems and powerflushing.

- **Reduce time on site - cleans systems in 1 hour**
- **Restore dirty systems - targeted dissolution of corrosion debris**



## Sentinel X100 Inhibitor

Leave-in protection against corrosion and limescale.

- **Ensure optimum system efficiency**
- **Protect against future system issues**



&



## Sentinel Eliminator Vortex®250 & 300 Filters

Powerful magnetic filtration of system debris.

- **Fast installation - 360° rotational T-piece allows flexibility in fitting**
- **Reduced intervention costs - duals seals, brass valves and T-piece**
- **Ease of service - withdraw magnet and flush, seals don't need to be replaced**

We also offer product options for hard water areas.



## Sentinel SESI

Electrolytic scale inhibitor for protecting hot water systems against limescale.

For peace of mind, confirm best practice water treatment for each heating system with independent water testing.



## Sentinel SystemCheck

Independent, in-depth analysis of system water quality.

- **Validation of correct cleaning and then treatment with Sentinel X100 Inhibitor**
- **Full report of recommendations provided via email**
- **Performance analysis available online**

# The SystemCare product package

SystemCare accommodates for the various fittings and water requirements encountered on the job.

	X800 Fast Acting Cleaner	X100 Inhibitor	Eliminator Vortex250 (isolation valve)	Eliminator Vortex300 (direct fit)	SESI
<b>PACK A</b> HARD WATER   DIRECT FIT	✓	✓		✓	✓
<b>PACK B</b> DIRECT FIT	✓	✓		✓	
<b>PACK C</b> HARD WATER   22mm COMPRESSION	✓	✓	✓		✓
<b>PACK D</b> 22mm COMPRESSION	✓	✓	✓		





**Sentinel Performance Solutions Ltd**

7650 Daresbury Park,  
Warrington, Cheshire, WA4 4BS  
United Kingdom.

Tel: +44 (0) 1928 704330

[www.sentinelprotects.com](http://www.sentinelprotects.com)